

Example:  
To be designed and sealed by a Texas Professional Engineer for specific project applications.

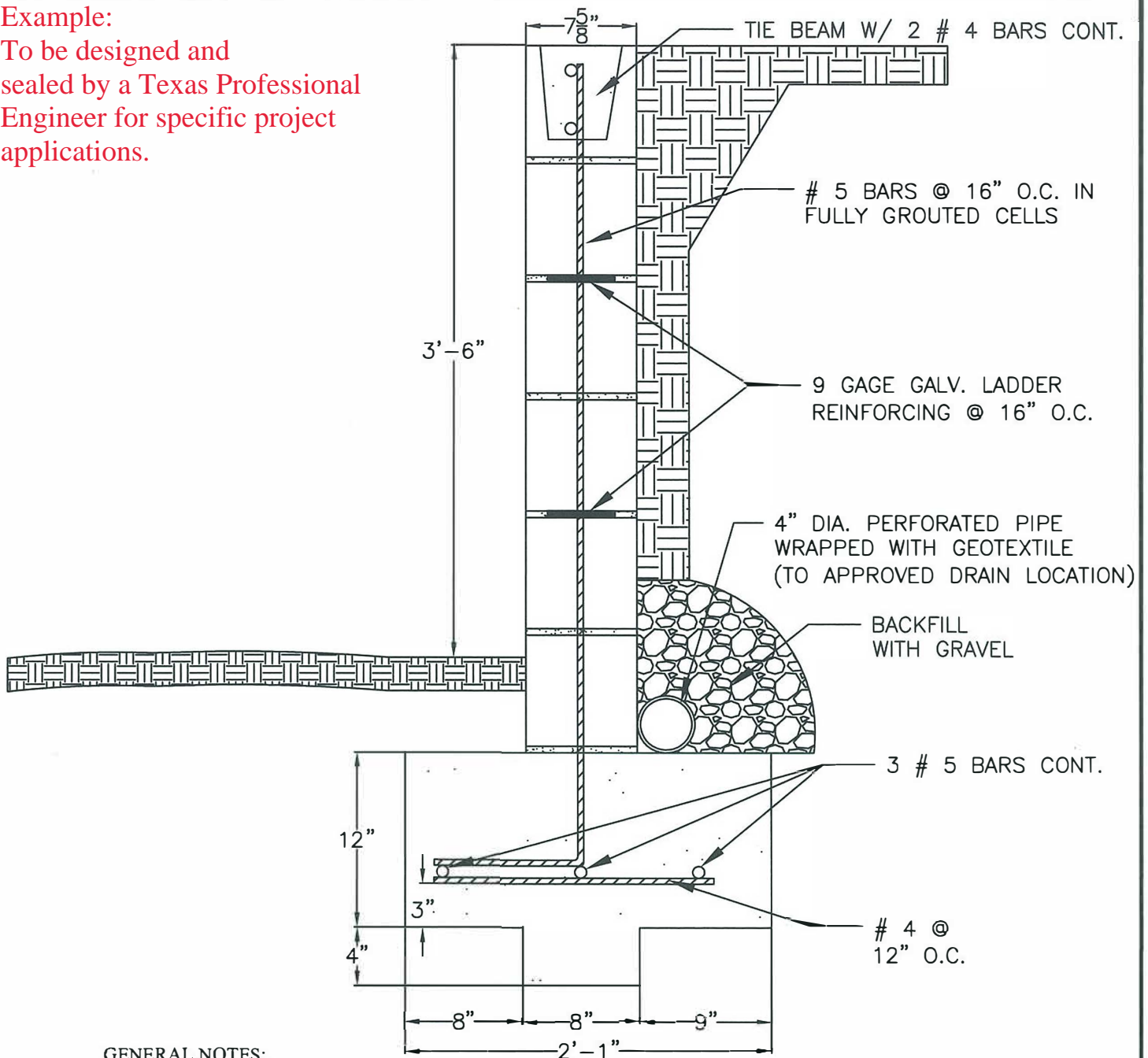

GENERAL NOTES:

1. FOR DRAINAGE, USE A 4" PERFORATED PIPE, AS SHOWN, OR OMIT MORTAR FOR EVERY OTHER VERTICAL JOINT IN THE FIRST COURSE ABOVE GROUND TO DRAIN IN OWN PROPERTY.
2. WATER SHALL NOT BE DRAINED TO ADJACENT PROPERTY.
3. NO SURCHARGE LOAD IS ALLOWED..
4. USE TYPE M OR TYPE S CONCRETE MASONRY UNITS W/ 1900 PSI COMPRESSIVE STRENGTH.
5. MIN. GROUT COMPRESSIVE STRENGTH = 2000 PSI

SHORT RETAINING WALL

NOT TO SCALE

SHORT RETAINING WALL